

## Bull's eye levels for installation in plates and housings

### SPECIFICATION

#### Sensitivity

- Type **10**: Angle minutes, bubble move by 2mm (only Version ALS)
- Type **40**: Angle minutes, bubble move by 2mm (only Version KT)

#### Identification no.

- No. **1**: without contrast ring
- No. **2**: with contrast ring (only version KT for d=12...18)

#### Housing

Aluminium, anodized, natural colour **ALS** /  
Viewing window, glass

Plastic, white **KT** /  
Viewing window, transparent

#### Filling

- colourless-transparent **K**
- green-transparent **G** (only Version KT)



### INFORMATION

Due to their cylindrical design, bull's eye levels GN 2281 are suitable for installation in plates and housings where they serve to check the horizontal position of jigs, machines and devices.

Bull's eye levels are not aligned, i.e. there is no reference to the external outline of the level. The vertical position must be ensured by aligning the holding building element.

The black housing of the version ALS creates a reflection at the edge of the bubble which significantly improves the readability. Version KT is available with contrast ring inside the air level housing (Identification no. 2) which creates the same effect.

Alternatively, the contrast can also be improved by a dark surface inside the mounting bore hole.

### ON REQUEST

- Other sensitivities

### GN 2281

Description	d	h1	h2	⚖️
GN 2281-KT-10-G-40-1	10	-	6	1
GN 2281-KT-10-K-40-1	10	-	6	1
GN 2281-KT-12-G-40-1	12	-	7	1
GN 2281-KT-12-G-40-2	12	-	7	1
GN 2281-KT-12-K-40-1	12	-	7	1
GN 2281-KT-12-K-40-2	12	-	7	1
GN 2281-KT-14-G-40-1	14	-	8	1
GN 2281-KT-14-G-40-2	14	-	8	1
GN 2281-KT-14-K-40-1	14	-	8	1
GN 2281-KT-14-K-40-2	14	-	8	1
GN 2281-KT-15-G-40-1	15	-	8	1
GN 2281-KT-15-G-40-2	15	-	8	1
GN 2281-KT-15-K-40-1	15	-	8	1
GN 2281-KT-15-K-40-2	15	-	8	1
GN 2281-KT-18-G-40-1	18	-	9	2
GN 2281-KT-18-G-40-2	18	-	9	2
GN 2281-KT-18-K-40-1	18	-	9	2
GN 2281-KT-18-K-40-2	18	-	9	2

Version ALS

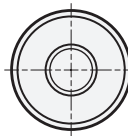
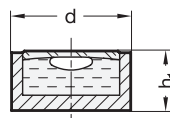

Version KT

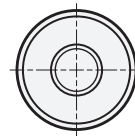
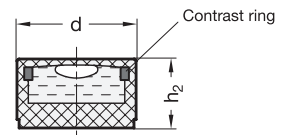

### GN 2281

Description	d	h1	h2	⚖️
GN 2281-ALS-10-K-10-1	10	6.9	-	1
GN 2281-ALS-12-K-10-1	12	6.4	-	2
GN 2281-ALS-14-K-10-1	14	6.2	-	2
GN 2281-ALS-15-K-10-1	15	7.4	-	3
GN 2281-ALS-18-K-10-1	18	7.3	-	4



Control elements 6